

CURVE TABLE					
CURVE No.	LENGTH	RADIUS	DELTA	CHORD DIRECTION	CHORD LENGTH
C1	147.90	500.00	16°56'54"	N53° 11' 23"W	147.36
C2	58.45	500.00	6°41'51"	N41° 22' 01"W	58.41
C3	44.93	350.00	7°21'20"	N41° 41' 45"W	44.90
C4	71.93	200.00	20°36'27"	N55° 40' 39"W	71.55
C5	33.82	90.00	21°31'44"	N55° 13' 00"W	33.62
C6	111.36	400.00	15°57'04"	N52° 25' 41"W	111.00
C7	55.59	400.00	7°57'45"	N64° 23' 06"W	55.54
C8	55.59	400.00	7°57'45"	N64° 23' 06"W	55.54
C9	66.30	400.00	9°29'47"	N55° 39' 20"W	66.22
C10	33.15	200.00	9°29'47"	N55° 39' 20"W	33.11
C11	28.22	200.00	8°05'01"	N26° 10' 00"E	28.19
C12	42.33	300.00	8°05'01"	N26° 10' 00"E	42.29
C13	411.61	1000.00	23°35'00"	N18° 25' 00"E	408.71
C14	164.64	400.00	23°35'00"	N18° 25' 00"E	163.48
C15	88.56	300.00	16°54'48"	N38° 39' 54"E	88.24

LINE TABLE		
LINE No.	LENGTH	BEARING
L1	31.38	N61°39'50"W
L2	41.00	N38°01'05"W
L3	1.75	N65°58'52"W
L4	46.66	N44°27'09"W
L5	240.35	S30°12'30"W
L6	48.88	N60°24'13"W
L7	109.35	N50°54'26"W
L8	95.33	N30°12'30"E
L9	61.42	N22°07'29"E
L10	140.16	N67°50'41"E
L11	116.42	S36°48'46"E
L12	109.01	S23°52'59"E

**NOTE:**  
 ○ OPEN CIRCLE INDICATES 1/2" CAPPED IRON ROD SET / FOUND STAMPED C.F. STARK, RPLS 5084  
 ● SOLID CIRCLE INDICATES CONTROL MONUMENT FOUND AS LABELED

**ONEOK PIPELINE NOTE:**  
 "ONEOK West Texas NGL Pipeline, L.L.C. operates and maintains a 30 foot wide Right-of-Way, as shown on the face of the Plat and referenced by Book 524, Page 41, shall be for the exclusive use of the pipelines right-of-way holder and shall not be used by any other utility provider without written consent of the easement holder. No lake, pond, building or other structure of permanent nature may be constructed upon or over said easement without written consent of the easement holder."

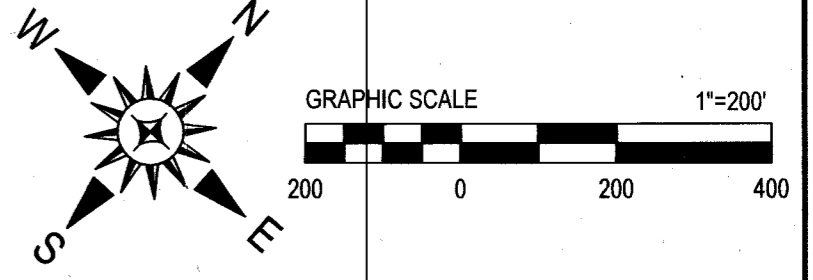
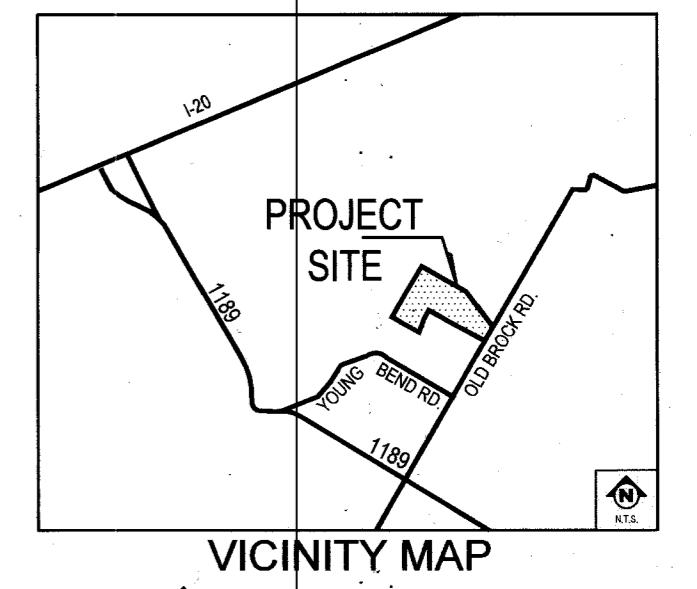

**OWNER:**  
 BLACKBURN HOLDINGS, LLC.  
 GIL BLACKBURN  
 8131 OLD BROCK ROAD  
 BROCK, TEXAS 76087  
 817-565-5255

TOTAL LINEAR FEET OF PRIVATE RIGHT OF WAY = 4,476 TO BE MAINTAINED BY THE HOA

STATE OF TEXAS }  
 COUNTY OF PARKER }

I hereby certify this plat is true and correct and was prepared from an actual survey of the property made under my supervision on the ground.

*Charles F. Stark* 2/14/2021  
 Charles F. Stark, R.P.L.S. Date

Texas Registration No. 5084  
 USE OF THIS ELECTRONIC SEAL/SIGNATURE AUTHORIZED BY CHARLES F. STARK, R.P.L.S. TEXAS REGISTRATION NO. 5084

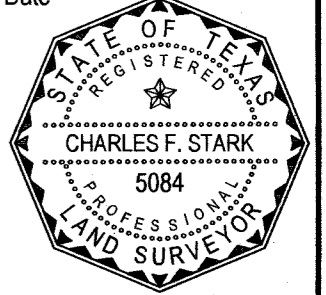

This plat represents property which has been platted without groundwater certification as prescribed in Texas Local Government Code Section 232.0032. Buyer is advised to question seller as to the groundwater availability.

FILED FOR RECORD  
 PARKER COUNTY, TEXAS PLAT RECORD  
 CABINET **E**, SLIDE **663**  
 DATE

20799.010.001.00  
 20799.010.002.50

18358  
 BR  
 D-19

**Final Plat**  
 Lots 1 thru 42, and Lot A, Block 1  
**THE RESERVE OF BROCK**

An Addition to Parker County, Texas  
 Being 97.82 Acres Situated in the  
 LEON COUNTY SCHOOL LAND SURVEY, ABSTRACT NO. 799  
 Parker County, Texas



6221 Southwest Boulevard, Suite 100  
 Fort Worth, Texas 76132  
 (O) 817.231.8100 (F) 817.231.8144  
 Texas Registered Engineering Firm F-10998  
 Texas Registered Survey Firm F-10158800  
 www.barronstark.com

JOB No. 379-9516  
 DATE JAN 2021  
**SHEET**  
 1 of 2

USER: CNTRHA SWIFT  
 PLOTTED ON: 2/20/21 12:41 PM  
 FILE NAME: I:\BARRONSTARK\SWIFT ENG\379-9516-18358-OLD BROCK ROAD ROAD CORNER DRIVING PLAT\379-9516-FINAL PLAT THE RESERVE OF BROCK.DWG

202105295 PLAT Total Pages: 2