

RECOMMENDED BY:  
*Scott Hassmar* 3/12/18  
 CITY ADMINISTRATOR DATE OF RECOMMENDATION

APPROVED BY:  
*Emilio Lopez* 3-12-18  
 MAYOR DATE OF APPROVAL

ATTEST:  
*Ramona Burns* 3-12-18  
 CITY SECRETARY DATE

**FINAL PLAT**  
 SCENIC WOOD ESTATES  
 AN ADDITION TO THE CITY OF RENO,  
 PARKER COUNTY, TEXAS  
 LOTS A & B, BLOCK 1: LOTS 1 - 65, BLOCK 1; LOTS 1 - 10, BLOCK 2;  
 LOTS 1 - 10, BLOCK 3; LOTS 1 - 11, BLOCK 4; LOTS 1 - 7, BLOCK 5.  
 BEING A 121.39 ACRES TRACT OF LAND OUT OF THE S. ERWIN SURVEY, ABSTRACT  
 NO. 2489 AND THE F. PEDEN SURVEY, ABSTRACT NO. 2772, PARKER COUNTY,  
 TEXAS, AND BEING ALL OF THAT CERTAIN TRACT OF LAND AS DESCRIBED IN DOC#  
 201804971, OFFICIAL RECORDS, PARKER COUNTY, TEXAS, AND A PORTION OF THAT  
 CERTAIN LOT 1, BLOCK 1 OF ROWDY WINGATE YATES ADDITION AS RECORDED IN  
 PLAT CABINET C, SLIDE 723, PLAT RECORDS, PARKER COUNTY, TEXAS.  
 MARCH 2018

ACCT. NO.: 17301  
 SCH. DIST.: 20  
 CITY: OPE  
 MAP NO.: 143

17113.001-001-70  
 E-52 22772.003-001-00  
 22489.002-004-00  
 22772.003-000-00

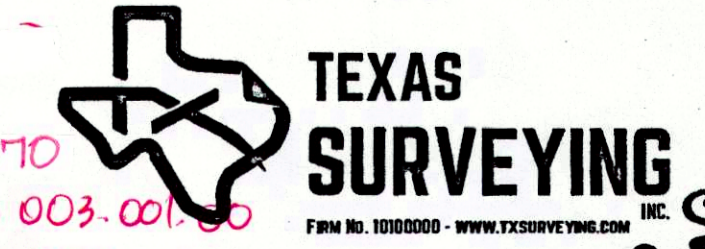

FORM NO. 10100000 - WWW.TXSURVEYING.COM

**SURVEYOR:**  
 KYLE RUCKER, R.P.L.S.  
 110 PALO PINTO  
 WEATHERFORD, TX 76086  
 817-594-0400

**OWNER/DEVELOPER:**  
 THURMAN DEVELOPMENT, LLC  
 A TEXAS LIMITED LIABILITY COMPANY  
 150 DEER CREEK DRIVE  
 ANNETTA, TX 76008  
 817-229-3080

