

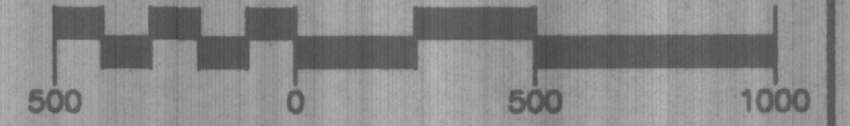

GRAPHIC SCALE: 1 IN = 500-FT

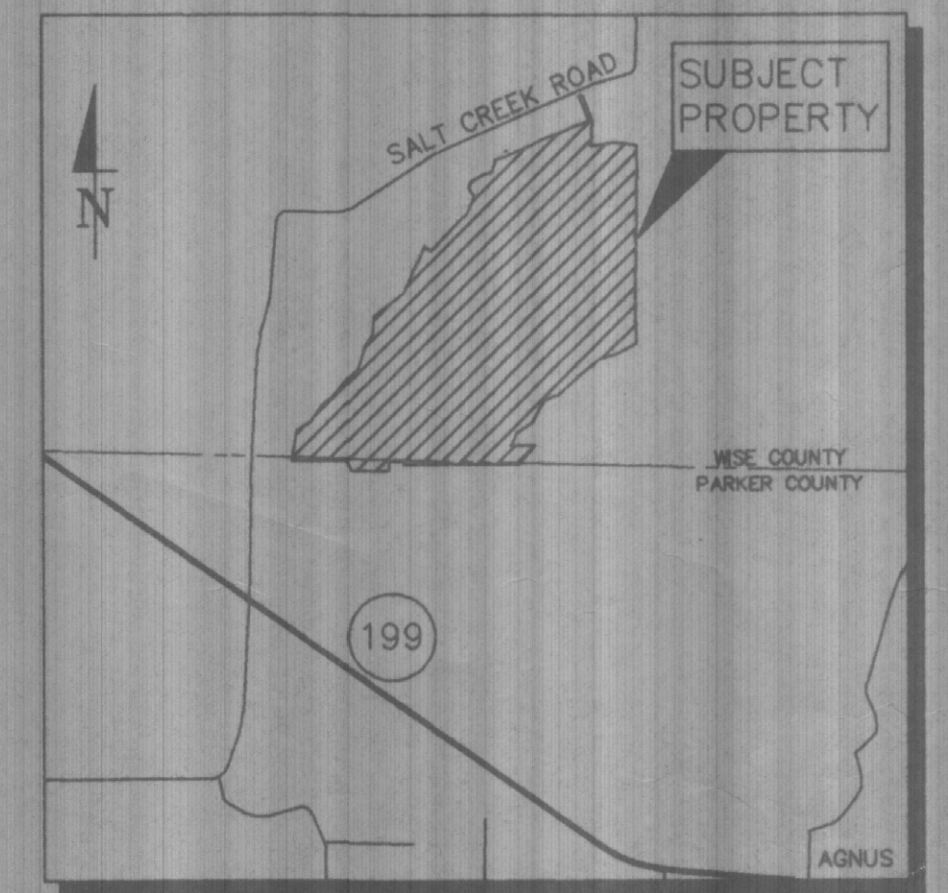

LOCATION MAP



SALES MAP
LOTS 1-65, BLOCK 1,
LOTS 1-81, BLOCK 2,
LOTS 1-13, BLOCK 3, AND
LOTS 1-13, BLOCK 4;
SALT CREEK

ACCT. NO: 17251
SCH. DIST: PO/W
CITY: Co
MAP NO: C.A

BEING 537.880 ACRES OF LAND IN THE
M.E.P. & P. RR. CO. SURVEY, ABSTRACT NUMBER 626, THE
W.T. WHARTON SURVEY, ABSTRACT NUMBER 1344, THE
W.G. LAWRENCE SURVEY, ABSTRACT NUMBER 1130, THE
J.C. HOBBS SURVEY, ABSTRACT NUMBER 1168, THE
RUSSELL LEE SURVEY, ABSTRACT NUMBER 1403 (WSE) 2842 (PARKER), AND THE
RUSSELL LEE SURVEY, ABSTRACT NUMBER 1459 (WSE) 2701 (PARKER)
WISE AND PARKER COUNTY, TEXAS

OWNER/DEVELOPER:
SALT CREEK PROPERTIES
3610 ANN ARBOR COURT
FORT WORTH, TEXAS 76109
(817) 929-4276

PREPARED MAY 8, 2000

CONTACT: JIM THOMASON
Surveyors:
D.K.B. & ASSOCIATES, LLC
REGISTERED PROFESSIONAL LAND SURVEYORS
323 HWY. 199 E.
SPRINGTOWN, TEXAS 76082
(817) 220-5888

LandCon Inc.
Engineers • Surveyors • Planners
2501 Parkview Dr., Suite 610, Fort Worth, Texas, 76102-5803
P.O. Box 100247, Fort Worth, Texas, 76185-0247
(817) 335-5065 FAX (817) 335-5067