

SCALE: 1" = 100'

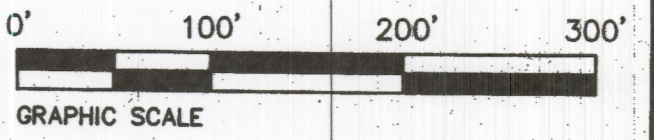

- LEGEND**
- CIRS 5/8 INCH IRON ROD SET WITH CAP STAMPED "JDJR"
 - CIRF 5/8 INCH IRON ROD FOUND WITH CAP STAMPED "JDJR" UNLESS OTHERWISE SHOWN
 - IRF IRON ROD FOUND
 - (CM) CONTROL MONUMENT
 - D.R.P.C.T. DEED RECORDS, PARKER COUNTY, TEXAS
 - M.R.P.C.T. MAP RECORDS, PARKER COUNTY, TEXAS
 - O.P.R.P.C.T. OFFICIAL PUBLIC RECORDS, PARKER COUNTY, TEXAS
 - INST. NO. COUNTY CLERK'S FILE NUMBER
 - VOL., PG. VOLUME, PAGE
 - CAB., SL. CABINET, SLIDE
 - D.E. DRAINAGE EASEMENT
 - S.W.M.E. SCREENING WALL MAINTENANCE EASEMENT
 - U.E. UTILITY EASEMENT

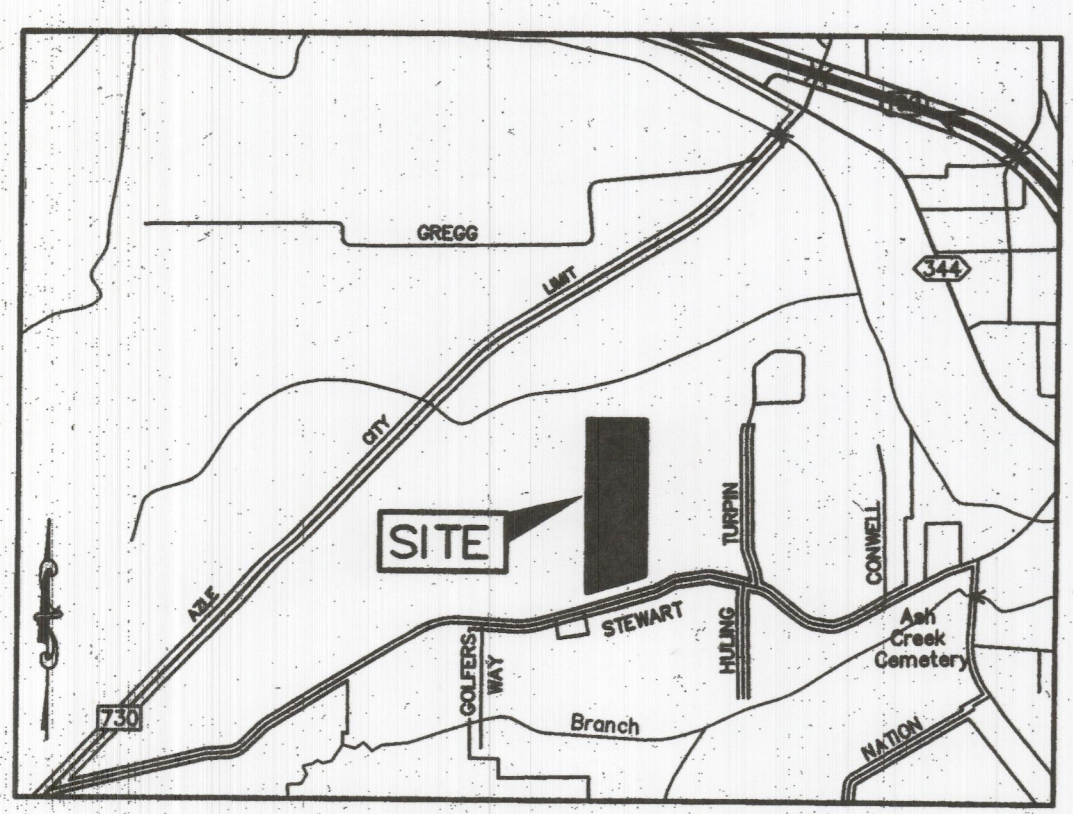
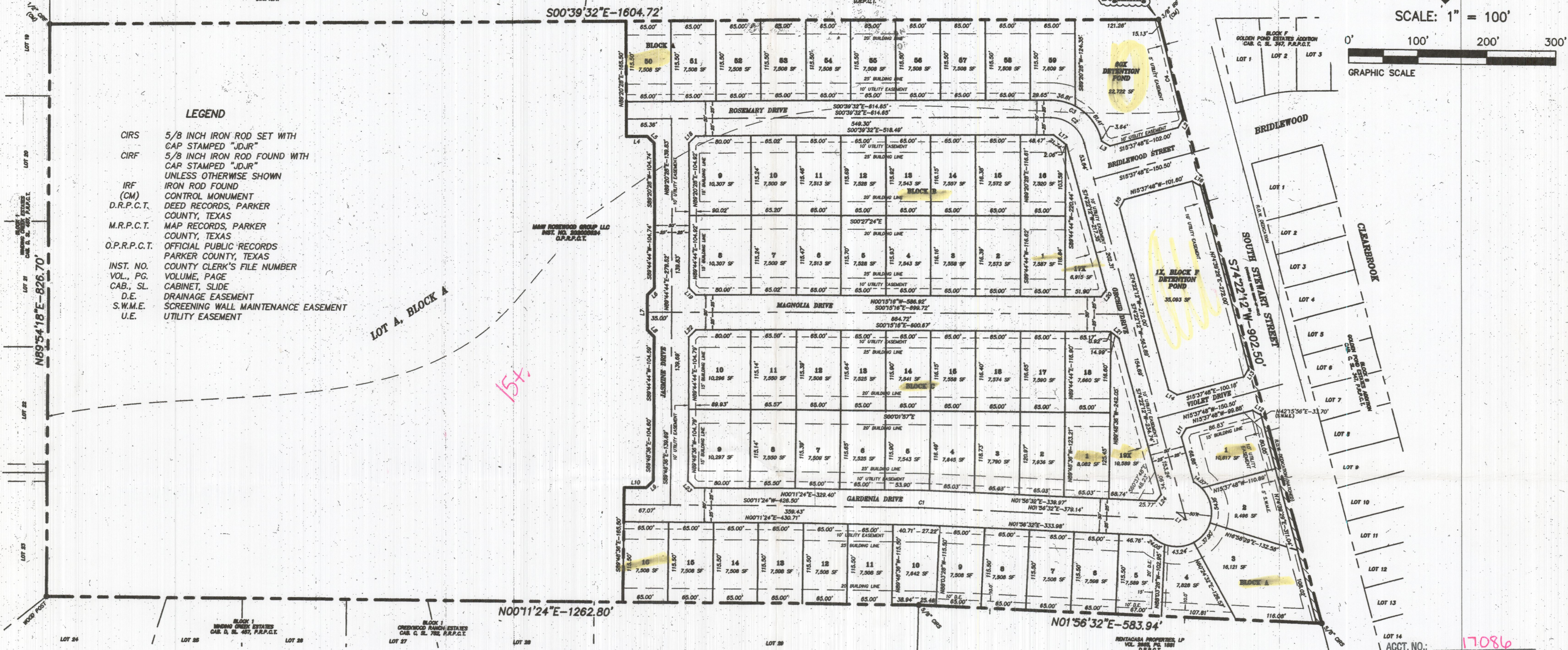

LOCATION MAP
N.T.S.

LINE TABLE

LINE #	BEARING	DISTANCE
L1	N38°09'22"E	16.93'
L2	N60°29'09"W	14.18'
L3	N29°22'12"E	14.14'
L4	N00°39'32"W	30.36'
L5	S44°20'28"W	14.14'
L6	N45°15'16"W	14.14'
L7	N89°44'44"E	50.00'
L8	S44°44'44"W	14.14'
L9	N44°48'36"W	14.14'
L10	S00°11'24"W	32.07'
L11	S60°37'48"E	14.14'
L12	S29°22'12"W	14.07'

LINE TABLE

LINE #	BEARING	DISTANCE
L13	N60°37'48"W	14.14'
L14	N29°22'12"E	14.14'
L15	S60°37'48"E	14.14'
L16	S29°30'51"W	14.11'
L17	S36°51'20"W	23.80'
L18	S45°39'32"E	14.14'
L19	N44°44'44"E	14.14'
L20	N52°56'32"W	12.12'
L21	S37°03'28"W	15.91'
L22	S45°15'16"E	14.14'
L23	N45°11'24"E	14.14'
L24	N51°50'38"W	11.82'

CURVE TABLE

CURVE #	ARC LEN.	RADIUS	DELTA	CH. BEAR.	CH. DIST.
C1	9.17'	300.00'	001°45'08"	N01°03'58"E	9.17'
C2	65.48'	50.00'	075°01'44"	S36°51'20"W	60.90'
C3	98.21'	75.00'	075°01'44"	N36°51'20"E	91.34'
C4	132.15'	2766.30'	002°44'13"	S75°51'56"W	132.14'

2,052,005,000.00
2,112,010,000.00

ACCT. NO.: 17086
SCH. DIST.: HZ
CITY: CAZ
MAP NO.: N-9

CASE NUMBER FP2019-0X
FINAL PLAT
ROSEWOOD ESTATES

BEING A 33.3211 ACRES
LOCATED IN THE J.G. REYNOLDS SURVEY, A-2052,
THE J.G. REYNOLDS SURVEY, A-1127 &
THE J. HAGGARD SURVEY, A- 593
AN ADDITION TO THE CITY OF AZLE, PARKER COUNTY, TEXAS

61 LOTS & 4 OPEN SPACES
JUNE 2020 SHEET 1 OF 2

JDJR ENGINEERS AND CONSULTANTS, INC.
TBPLS Firm No. 100356-00
ENGINEERS • LAND PLANNERS • SURVEYORS
2500 Texas Drive Suite 100 Irving, Texas 75062
Tel 972-252-5367 Fax 972-252-8968

PREPARED BY: BJC
DATE: AUG. 5, 2020
SCALE: 1" = 100'

DRAWN BY: BJC
CHECKED BY: KMH

OWNER:
M & W ROSEWOOD GROUP LLC
1000 N. BELT LINE ROAD, SUITE 204
IRVING, TEXAS 75061
CONTACT: MIKE NAWAR
972-333-0413

JDJR PROJECT NO. 1258-1-19
© COPYRIGHT 2020

E 572