

REMAINDER OF
CALLED 45,598 ACRES
D.R. HORTON -
TEXAS, LTD.
INST. NO. 201926981
O.P.R.P.C.T.

REMAINDER OF
LOT 2
MCCASLAND ADDITION, LOTS 1 & 2
CAB. D. SLIDE 262
P.R.P.C.T.

REMAINDER OF
CALLED 45,598 ACRES
D.R. HORTON -
TEXAS, LTD.
INST. NO. 201926981
O.P.R.P.C.T.

30' COLT GATHERING L.P. PIPELINE EASEMENT AREA
INST. NO. 202020326
O.P.R.P.C.T.

20' COLT GATHERING L.P.
TEMPORARY WORK AREA
INST. NO. 202020326
O.P.R.P.C.T.

APPROXIMATE LOCATION OF VARIABLE WIDTH UTILITY EASEMENT
CAB. D. SLIDE 262, P.R.P.C.T.

5.0 ACRES
JOHN DANIEL DENBOW
INST. NO. 201709856
O.P.R.P.C.T.

ACCT NO: 16554
SCH DIST: WE
CITY: CWE

72.688 ACRES
TOMMY BULLARD AND WIFE, JOHANNA BULLARD
VOL. 1640, PG. 997
D.R.P.C.T.

WATER,
WASTEWATER AND
ELECTRIC EASEMENT
INST. NO. 202032158
O.P.R.P.C.T.

30' COLT GATHERING L.P.
PIPELINE EASEMENT AREA
INST. NO. 202020325
O.P.R.P.C.T.

20' COLT GATHERING L.P.
TEMPORARY WORK AREA
INST. NO. 202020325
O.P.R.P.C.T.

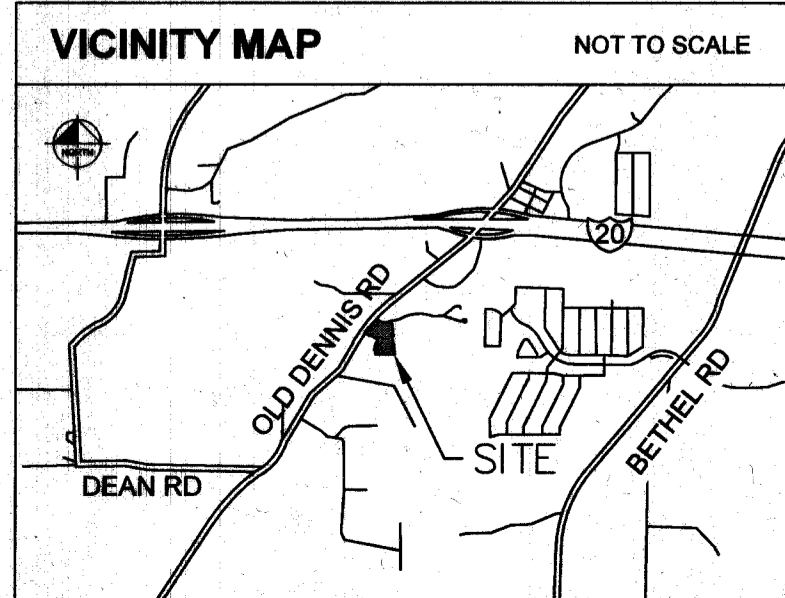

LEGEND	
D.R.P.C.T.	DEED RECORDS OF PARKER COUNTY, TEXAS
P.R.P.C.T.	PLAT RECORDS OF PARKER COUNTY, TEXAS
IRF	IRON ROD FOUND
IRFC	IRON ROD WITH CAP FOUND
IRSC	IRON ROD WITH "KHA" CAP SET
VOL.	VOLUME
PG.	PAGE
INST.	INSTRUMENT No.
B.L.	BUILDING LINE
DE	DRAINAGE EASEMENT
SSE	SANITARY SEWER EASEMENT
WME	WALL MAINTENANCE EASEMENT
UE	UTILITY EASEMENT
VAM	VISIBILITY, ACCESS, & MAINTENANCE ESMT.
MIN.FFE	MINIMUM FINISHED FLOOR ELEVATION
	STREET NAME CHANGE

LINE TYPE LEGEND	
	BOUNDARY LINE
	EASEMENT LINE
	BUILDING LINE

NORTH

GRAPHIC SCALE IN FEET

1" = 60' @ 18X24

FINAL PLAT RANCHES WEST PHASE 1

BLOCK A, LOTS 1-17; BLOCK B, LOTS 1-12;
BLOCK C, LOTS 1-20; BLOCK D, LOTS 1-30;
BLOCK E, LOTS 1-9; BLOCK F, LOTS 1-21;
BLOCK G, LOTS 1-26; BLOCK H, LOT 1;
BLOCK I, LOT 1; BLOCK J, LOT 1;
BLOCK K, LOT 1

131 RESIDENTIAL LOTS
8 OPEN SPACE LOTS

33.797 ACRES OUT OF THE JOHN DAVIS, A-349
CITY OF WEATHERFORD, PARKER COUNTY, TEXAS

OWNER:
D.R. Horton - Texas, Ltd.
6751 North Freeway
Fort Worth, Texas 76131
P: (817) 230-0800
Contact: Justin Bosworth

APPLICANT:
Kimley-Horn and Associates, Inc.
6160 Warren Pkwy., Suite 210
Frisco, TX 75335
P: (817) 335-3580
Contact: Rob Myers, PE

Kimley»Horn

6160 Warren Parkway, Suite 210
Frisco, Texas 75034

Tel. No. (972) 335-3580
FIRM # 10193822

Scale 1" = 60'	Drawn by SG	Checked by KHA	Date OCT. 2020	Project No. 068517096	Sheet No. 4 OF 6
-------------------	----------------	-------------------	-------------------	--------------------------	---------------------

20349.040.000.00 ALL
20349.046.001.00 ALL
20349.046.001.50

E 621