

\$55,000 lot value per acre

201607284 PLAT Total Pages: 3

D 526

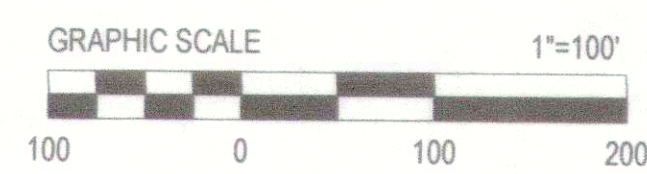

INTERSTATE HWY. 20

- TOTAL NUMBER OF RESIDENTIAL LOTS = 113 LOTS.
- AVERAGE LOT SIZE - 70'x130' (9,100 sf).
- SMALLEST LOT SIZE - (9,001 sf).
- BUILDING SETBACK LINES FRONT - 25 FEET SIDE & REAR - 10 FEET
- SEWER SERVICE-CITY OF WILLOW PARK
- WATER SERVICE-CITY OF WILLOW PARK
- A PORTION OF THIS PROPERTY DOES LIE WITHIN A DESIGNATED 'AE' FLOODPLAIN ZONE PER FIRM MAP #48367C0425E
- THIS PROPERTY IS IN ALEDO ISD
- EXIST. ZONING "R5"
- LOT 5, BLOCK A SHALL BE REGULATED TO "PARK" USE & PROPOSED AS A DRAINAGE EASEMENT IN ITS ENTIRETY.

APPROVED BY THE CITY OF WILLOW PARK

APPROVED BY CITY COUNCIL CITY OF WILLOW PARK, TEXAS

SIGNED *R.L. Henderson* DATE 4/6/16
MAYOR

SIGNED *[Signature]* DATE 4/6/16
CITY ADMINISTRATOR



BASIS OF BEARING FOR THIS PLAT IS TEXAS STATE PLANE COORDINATE SYSTEM, NORTH CENTRAL ZONE NAD83 & NAVD88.

P.O.B.
N. 6952969.25
E. 2230605.96

ACCT. NO.:
SCH. DIST.:
CITY:
MAP NO.:

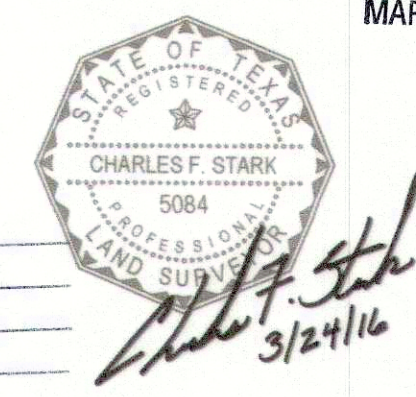

[Signature]
3/24/16

ACCT. NO.: 14999
SCH. DIST.: AL
CITY: WP
MAP NO.: K-14

FINAL PLAT

LOTS 1-21, BLOCK A *Blk 1*
LOTS 1-31, BLOCK B *Blk 2*
LOTS 1-30, BLOCK C *Blk 3*
LOTS 1-5, BLOCK D *Blk 4*
LOT 1-27, BLOCK E *Blk 5*

MEADOW PLACE ESTATES
AN ADDITION TO THE CITY OF WILLOW PARK
PARKER COUNTY, TEXAS

BEING A REPLAT OF A PORTION OF LOT 1, BLOCK 2 TRINITY MEADOWS AS RECORDED IN CABINET A, SLIDE 740, PLAT RECORDS, PARKER COUNTY, TEXAS BEING 39.12 ACRES SITUATED IN THE JOHN FROMAN SURVEY, ABSTRACT NO. 471

B
Barron-Stark-Swift
Consulting Engineers
Together.

6221 Southwest Boulevard, Suite 100
Fort Worth, Texas 76132
(O) 817.231.8100 (F) 817.231.8144
Texas Registered Engineering Firm F-10998
Texas Registered Survey Firm F-10158800
www.barronstark.com

OWNER:
Parker County Holdings, LLC
5354 Airport Freeway
Haltom City, Texas 76117
817-371-6776

JOB No. 291-9307
REV. JANUARY 2016
SHEET NO.
1 of 3

18483.002.001.00