

M. E. P. & P. R.R. CO. SURVEY
ABSTRACT No. 616

BURDOCK
V. 1275, P. 221

G. BOOTHE SURVEY
ABSTRACT No. 146
MURRAY
V. 160, P. 700

T. & P. R.R. CO SURVEY
ABSTRACT No. 1373

JENNINGS
V. 1444, P. 251

JENNINGS
V. 1444, P. 254

JENNINGS
V. 2879, P. 1925

JENNINGS LANE
V. 2335, P. 265

DINIAS
V. 1564, P. 1546

CURVE	RADIUS	ARC	CHORD BEARING	CHORD
C1	120.00'	32.77'	N 82°26'18" W	32.67'
C2	120.00'	61.35'	N 59°58'05" W	60.68'
C3	120.00'	64.21'	N 29°59'38" W	63.44'
C4	120.00'	30.50'	N 07°23'09" W	30.41'
C5	220.00'	40.94'	N 05°13'34" E	40.88'
C6	220.00'	65.78'	N 19°07'26" E	65.54'
C7	220.00'	73.38'	N 37°14'45" E	73.04'
C8	220.00'	77.81'	N 56°55'58" E	77.40'
C9	220.00'	85.82'	N 78°14'23" E	85.28'
C10	135.15'	77.44'	S 74°10'12" E	76.38'
C11	135.15'	18.33'	S 61°38'29" E	18.32'
C12	135.15'	59.10'	S 78°03'23" E	58.63'
C13	210.00'	57.34'	S 82°45'44" E	57.17'
C14	210.00'	133.38'	S 56°44'36" E	131.15'
C15	70.00'	52.61'	N 10°23'11" E	51.38'
C16	70.00'	72.20'	N 61°27'55" E	69.04'
C17	70.00'	71.69'	S 59°38'47" E	68.60'
C18	70.00'	79.77'	S 02°20'25" W	75.53'
C19	70.00'	52.81'	S 56°36'05" W	51.56'
C20	70.00'	48.74'	N 81°50'32" W	47.76'
C21	210.00'	32.04'	S 17°39'06" E	32.01'
C22	300.00'	69.96'	S 06°35'58" E	69.80'
C23	120.00'	17.95'	S 04°12'11" E	17.93'
C24	120.00'	37.50'	S 17°26'27" E	37.35'
C25	180.00'	83.18'	S 13°09'22" E	82.44'
C26	180.00'	80.68'	S 12°55'23" W	80.01'
C27	180.00'	94.94'	S 40°52'28" W	93.84'
C28	180.00'	54.82'	S 64°42'34" W	54.61'
C29	180.00'	51.22'	S 81°35'12" W	51.05'
C30	60.00'	94.41'	N 45°11'00" W	84.97'
C31	160.00'	249.99'	N 44°39'17" E	225.33'
C32	75.15'	37.42'	S 76°19'15" E	37.03'
C33	75.15'	5.64'	S 59°54'21" E	5.64'
C34	195.15'	111.82'	S 74°10'12" E	110.29'
C35	150.00'	202.38'	S 51°55'58" E	187.38'
C36	240.00'	55.97'	S 06°35'58" E	55.84'
C37	180.00'	83.18'	S 13°09'22" E	82.44'
C38	120.00'	55.45'	S 13°09'22" E	54.96'
C39	120.00'	187.78'	S 44°54'37" W	169.20'
C40	400.00'	112.37'	N 27°12'31" W	112.00'
C41	400.00'	40.46'	N 38°09'15" W	40.44'
C42	180.00'	124.93'	N 19°59'21" W	122.44'
C43	300.00'	26.96'	N 02°40'48" W	26.95'
C44	300.00'	95.10'	N 14°20'07" W	94.70'
C45	180.00'	73.23'	N 11°45'39" W	72.73'
C46	240.00'	59.59'	S 07°13'08" E	59.44'
C47	240.00'	38.05'	S 18°52'27" E	38.01'
C48	240.00'	44.19'	S 18°08'28" E	44.13'
C49	240.00'	53.45'	S 06°29'09" E	53.34'
C50	240.00'	19.42'	S 02°25'26" E	19.42'
C51	240.00'	147.15'	S 22°18'27" E	144.86'
C52	340.00'	109.73'	S 31°54'23" E	109.25'

LINE	BEARING	DISTANCE
L1	S 00°25'20" W	159.27'
L2	S 89°44'20" E	39.70'
L3	N 00°25'20" E	158.54'
L4	N 89°53'40" E	30.00'
L5	N 00°06'20" W	53.08'

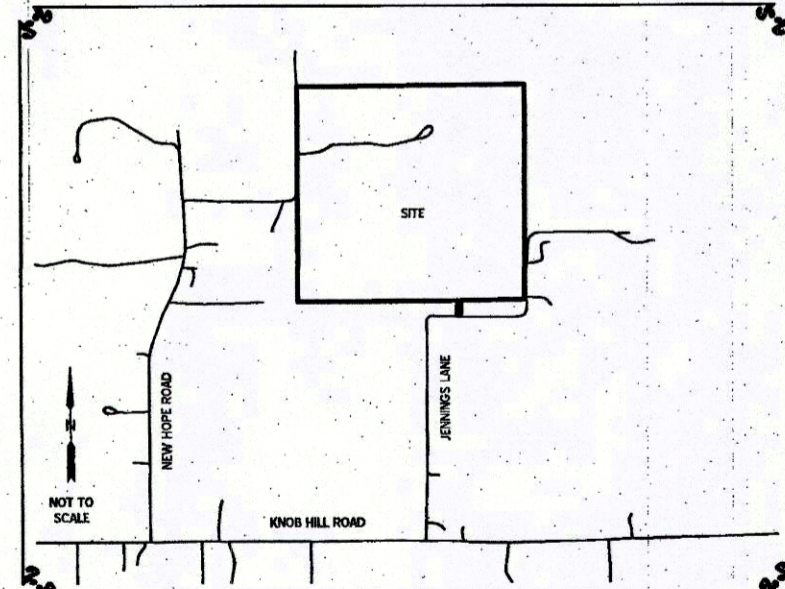

LINE	BEARING	DISTANCE
EL1	N 00°04'14" W	96.86'
EL2	S 29°27'39" E	58.75'
EL3	N 00°04'14" W	135.84'
EL4	S 04°18'23" W	70.14'
EL5	S 68°53'41" E	176.12'
EL6	S 79°19'52" E	121.78'
EL7	S 89°40'48" E	50.42'
EL8	N 52°38'22" E	142.90'
EL9	S 52°50'41" E	54.67'
EL10	S 64°21'16" W	204.06'
EL11	N 64°21'16" E	173.76'
EL12	S 52°50'41" W	49.33'
EL13	N 52°38'22" E	167.80'
EL14	S 89°40'48" E	55.95'
EL15	S 79°19'52" W	112.34'
EL16	N 66°53'41" E	143.14'
EL17	S 04°18'23" W	40.42'
EL18	N 00°04'14" W	122.01'
EL19	N 29°27'39" W	58.75'
EL20	N 00°04'14" W	154.90'

New Hope Road

SOUTER
V. 2103, P. 350

MEYER, KNIGHT &
WILLIAMS, LLP
V. 2464, P. 1821

SURVEYOR:
KYLE RUCKER, R.P.L.S.
104 S. WALNUT STREET
WEATHERFORD, TX, 76086
817-594-0400

OWNER/DEVELOPER:
THURMAN DEVELOPMENT, LLC
A TEXAS LIMITED LIABILITY COMPANY
150 DEER CREEK DRIVE
ANNETTA, TX 76008
817-229-3080



FINAL PLAT

LOTS 1-60, BLOCK 1; LOTS 1-24, BLOCK 2; LOTS 1-24, BLOCK 3; LOTS 1-23, BLOCK 4
LOST HORIZON ESTATES
AN ADDITION TO PARKER COUNTY, TEXAS
FEBRUARY 2020

WEATHERFORD BRANCH - 817-594-0400
TEXAS SURVEYING
INC.
FIRM NO. 10100000 - WWW.TXSURVEYING.COM

ACCT. NO.:
SCH. DIST.:
CITY:
MAP NO.:

2158.001.000.00

E 486