

LOT #	BLOCK	LOT AREA (SF)	LOT #	BLOCK	LOT AREA (SF)
15	1	10,301	1	3	10,652
16	1	9,450	2	3	9,450
17	1	9,450	3	3	9,450
18	1	9,750	16	3	10,831
19	1	12,137	17	3	18,999
20	1	12,322	18	3	13,285
21	1	12,666	19	3	9,450
22	1	11,379	20	3	9,450
23	1	9,450	21	3	9,450
24	1	9,450	22	3	9,450
25	1	9,450	23	3	9,450
26	1	9,450	24	3	9,450
27	1	9,450	25	3	11,475
28	1	9,450	26	3	14,082
29	1	9,450	27	3	19,667
30	1	9,450			
31	1	10,125			
1	2	10,658	14	4	9,755
2	2	16,171	15	4	9,770
3	2	13,680	16	4	9,147
4	2	12,250	17	4	9,173
5	2	15,361			
6	2	10,898	1	5	13,014
7	2	9,498	2	5	9,457
8	2	9,450	3	5	9,457
9	2	9,450	4	5	9,459
10	2	11,475	5	5	9,461
11	2	14,900	6	5	9,466
			7	5	9,466
			8	5	9,466
			9	5	9,470

LOT #	BLOCK	LOT AREA (SF)	LOT #	BLOCK	LOT AREA (SF)
4	3	15,855	18	4	10,436
5	3	13,365	19	4	10,935
6	3	12,692	20	4	9,450
7	3	9,466	21	4	9,450
8	3	9,450	22	4	9,450
9	3	9,450	23	4	9,450
10	3	9,450	24	4	9,450
11	3	9,450	25	4	9,450
12	3	9,450	26	4	9,450
13	3	12,972	27	4	9,450
14	3	15,293	28	4	9,450
15	3	11,126	29	4	13,834
1	4	9,583	10	5	9,473
2	4	10,872	11	5	9,475
3	4	9,395	12	5	9,477
4	4	9,450	13	5	9,479
5	4	9,450	14	5	9,482
6	4	9,450	15	5	10,778
7	4	9,450	16	5	291,196
8	4	9,450			
9	4	14,697			
10	4	13,814			
11	4	12,790			
12	4	12,551			
13	4	9,679			

- GENERAL NOTES:
- BEARINGS CORRELATED TO THE GPS NETWORK, NAD 83 NORTH CENTRAL TEXAS ZONE 4202.
  - ALL LOT LINES SHOWN HEREON SHALL POSSESS A 5.0' (FIVE FOOT) UTILITY & DRAINAGE EASEMENT RUNNING PARALLEL WITH THE LOT LINE, UNLESS NOTED OTHERWISE. FOR INTERIOR SIDE LOT LINES, THE EASEMENTS SHALL RUN ON BOTH SIDES OF THE LOT LINE FOR THE ENTIRE LENGTH OF THE LOT LINE.
  - BUILDING LINE SETBACKS PER THE FOLLOWING:  
 FRONT YARD = 25.0'  
 SIDE YARD = 7.5'  
 REAR YARD = 20.0'
  - Minimum Finished Floor elevations and WSEL lines provided by Jordan Engineering, LLC. Surveyor not responsible for data provided on plot.

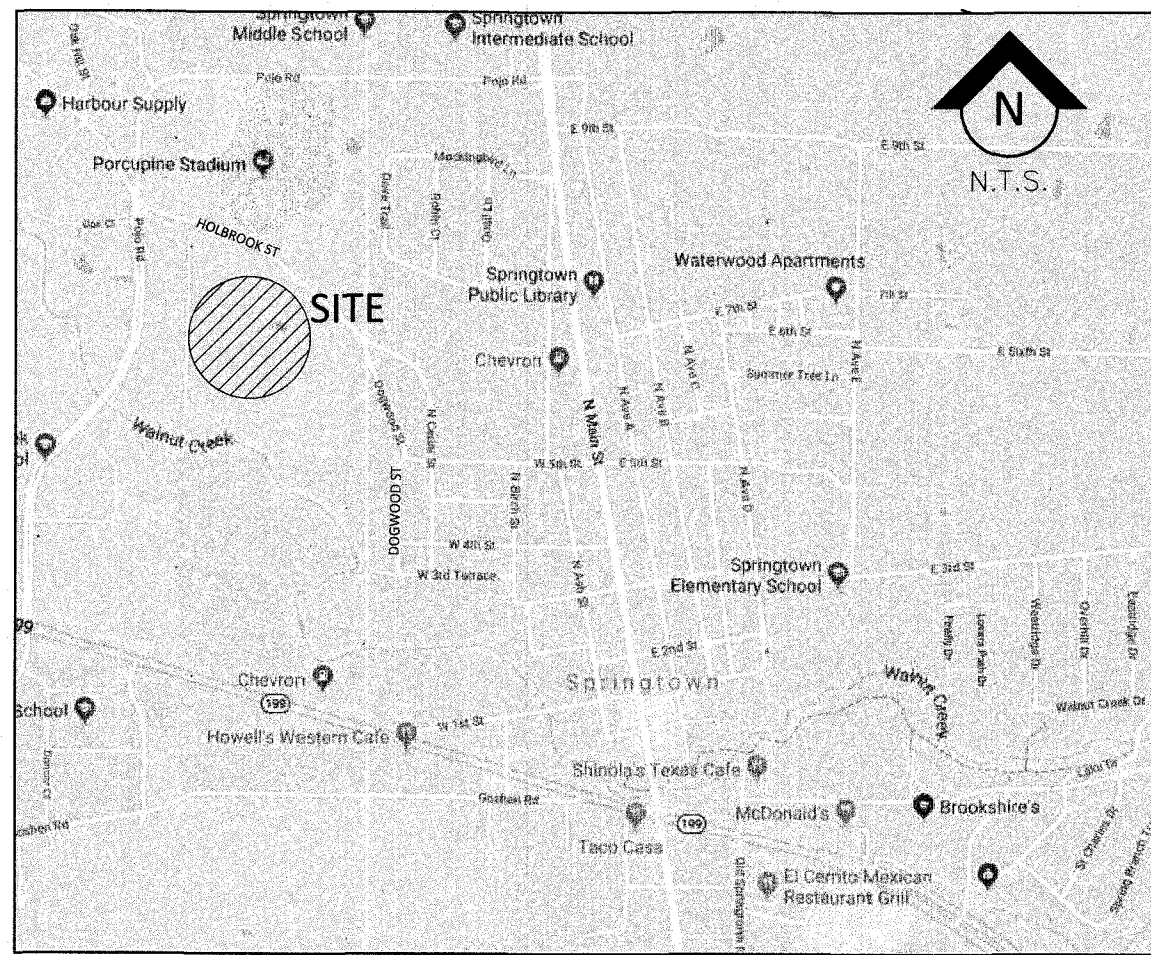

STEVENS LAND SURVEYING, PLLC  
 P.O. BOX 26951  
 FORT WORTH, TEXAS 76126  
 817-696-9775  
 FIRM REGISTRATION #10194023

LOCATION MAP

20242.028.000.00  
 20242.032.000.00

ACCT NO: 13588  
 SCH DIST: SP  
 CITY: CSP

**OWNER / DEVELOPER**  
 FEATHER EDGE HOLDINGS LLC  
 560 N. KIMBALL AVENUE, SUITE 140  
 SOUTHLAKE, TX 76092

**FINAL PLAT OF  
 HOLBROOK FARM PHASE 3**

LOTS 15-31, BLOCK 1;  
 LOTS 1-11, BLOCK 2;  
 LOTS 1-27, BLOCK 3;  
 LOTS 1-29, BLOCK 4;  
 LOTS 1-16, BLOCK 5;  
 BEING 37.560 ACRES OF LAND SITUATED IN THE WM  
 COPELAND SURVEY, ABSTRACT NUMBER 242  
 AN ADDITION TO THE CITY OF SPRINGTOWN,  
 PARKER COUNTY, TEXAS

E691