

LINE	BEARING	DISTANCE
LI	S 72°41'31" E	9.93'

SURVEYOR:
KYLE RUCKER, R.P.L.S.
104 S. WALNUT ST
WEATHERFORD, TEXAS, 76086
817-594-0400

OWNER/DEVELOPER:
HAROLD G. ANDERSON
870 LAZY BEND ROAD
MILLSAP, TEXAS 76066

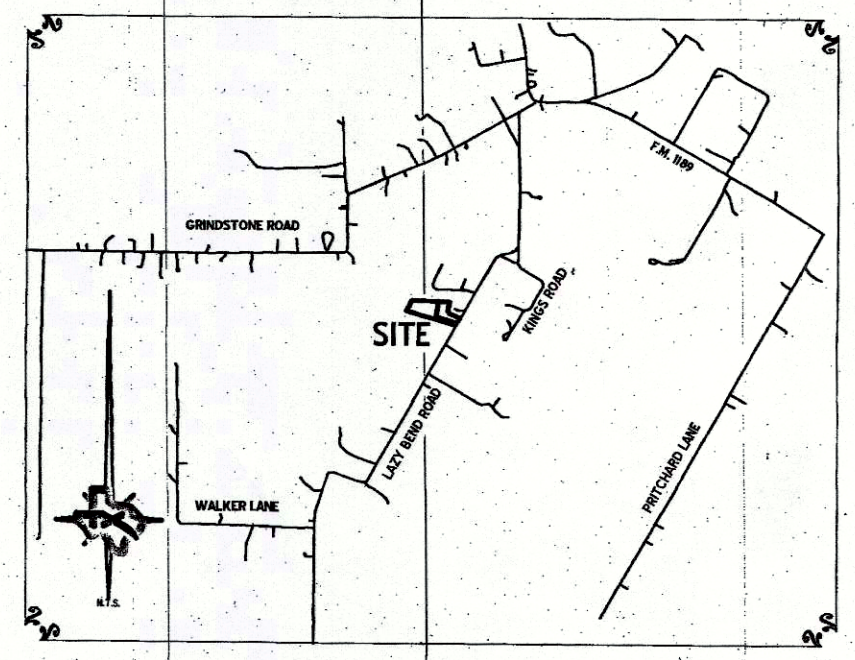

J. W. PEACOCK SURVEY
ABSTRACT No. 2033
GILBREATH
201326165
ACCT. NO.: 13005
SCH. DIST.: DR
CITY: D-19
MAP NO.:

FINAL PLAT OF
LOTS 1 AND 2,
H. ANDERSON ADDITION,
AN ADDITION TO
PARKER COUNTY, TEXAS
6.216 ACRES TRACT OF LAND OUT OF THE B.F.
MORROW SURVEY, ABSTRACT NO. 2033,
PARKER COUNTY, TEXAS.
JANUARY 2020

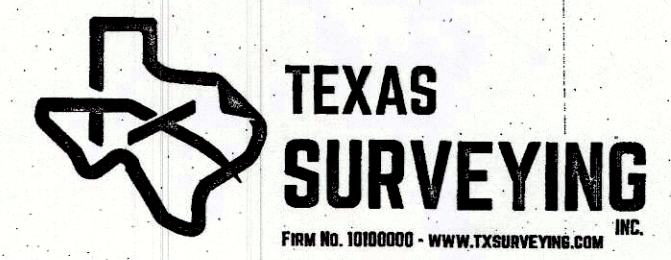

E 457

22-033-001-003-00 22-033-001-004-00