

LOCATION MAP

SCALE: 1" = 2000'

SURVEYOR:

GRANT ENGINEERING, INC.
3244 HEMPHILL STREET
FORT WORTH, TEXAS 76110-4014
817-923-3131 VOICE
817-923-4111 FAX

Doc# 785961
Book 2896 Page 607

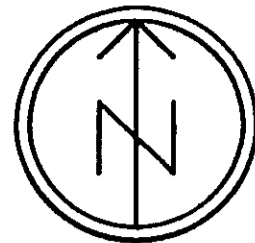

SCALE: 1" = 50'

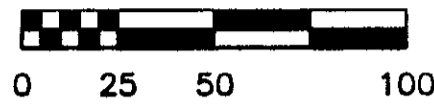

OWNERS:

AS TO LOT 1:
MS. JACKIE L. FRENCH
212 SANDY CREEK TRAIL
WEATHERFORD, TEXAS 76085
817-441-8844
VOL. 2842, P. 77

AS TO LOT 2:
BLAKE EVANS AND CAROL EVANS
P. O. BOX 674
CROSS PLAINS, TEXAS 76443
325-643-5410
VOL. 2857, P. 25

AS TO LOT 3:
GUY C. CLAPP
4813 PARKER HENDERSON ROAD
FORT WORTH, TEXAS 76119
817-536-6050
VOL. 2840, P. 439

Grant Engineering, Inc.

Engineers Surveyors Planners
3244 Hemphill Street Fort Worth, Texas 76110-4014 817-923-3131

NO PART OF THE SUBJECT PROPERTY LIES WITHIN THE 100-YEAR FLOOD PLAIN ACCORDING TO THE FEMA MAP WITH THE FOLLOWING DESIGNATION: ZONE X COMMUNITY 481164 PANEL 0425-E EFF. DATE 9-26-08

APPROVED BY THE CITY OF WILLOW PARK, TEXAS FOR PREPARATION OF FINAL PLAT

Mari Blanton 2/3/12
MAYOR DATE

Fuel Hoffman 2/10/12
CITY SECRETARY DATE

Candice Scott 2/10/12
CITY ADMINISTRATOR DATE

David Fay 2/14/12
PLANNING AND CHAIRMAN DATE

EASEMENT LINE TABLE

LINE	BEARING	LENGTH
L-1	S 71°29'00" E	71.19
L-2	N 18°31'00" E	30.00
L-3	S 71°29'00" E	209.27
L-4	N 63°31'00" E	14.14
L-5	N 18°31'00" E	90.00
L-6	S 71°29'00" E	25.00
L-7	S 18°31'00" W	90.00
L-8	S 26°29'00" E	14.14
L-9	S 71°29'00" E	56.00
L-10	S 18°31'00" W	30.00
L-11	N 71°29'00" W	310.27
L-12	N 74°13'07" E	35.36
L-13	N 25°13'03" E	38.32

I HEREBY CERTIFY THAT THE PLAT AS SHOWN HEREON IS A TRUE AND CORRECT REPRESENTATION OF THE FACTS AS FOUND BY A BOUNDARY SURVEY PERFORMED ON THE GROUND IN DECEMBER, 2010, AND THAT THE LOT CORNERS HAVE BEEN SET ACCORDING TO THE LINES AND DIMENSIONS AS SHOWN HEREON.

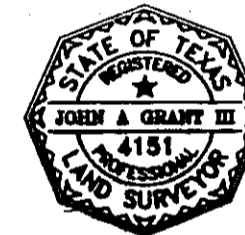

John A. Grant III 1-20-12

JOHN A. GRANT, III
REGISTERED PROFESSIONAL
LAND SURVEYOR 4151

ACCT. NO: 12060
SCH. DIST: AL
CITY: WP
MAP NO: L-10

NONE OF THE EXISTING STRUCTURES LOCATED ON THIS PROPERTY ENCROUGH ON ANY OF THE EASEMENTS SHOWN ON THIS PLAT

**EL CHICO ADDITION
REPLAT**

LOTS 1, 2 & 3, BLOCK 72R1

A REPLAT OF

PORTIONS OF BLOCKS 19R1 AND 72R1
EL CHICO ADDITION

CITY OF WILLOW PARK, PARKER COUNTY, TEXAS

AS RECORDED IN

CABINET D, PAGE 115

PLAT RECORDS, PARKER COUNTY, TEXAS

PLAT RECORDED IN **D**
PLAT CABINET
SLIDE **107**
DATE **2-16-12**

1.7637 ACRES
OCTOBER, 2011

SHEET 1 OF 2

