

201822574 PLAT Total Pages: 1  
 A. GLOVER SURVEY ABSTRACT NO. 1753

POINT OF BEGINNING  
 NORTH:6943272.31  
 EAST:2146583.59  
 NAD 83, ZONE 4202 (GRID)

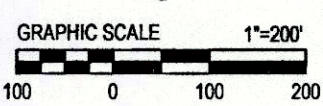

LINE TABLE		
LINE No.	LENGTH	BEARING
L1	90.23	S30°32'46"E
L2	51.31	S25°28'55"E
L3	39.07	S22°29'42"E
L4	65.22	S16°50'11"E
L5	116.35	S12°39'10"E
L6	25.93	S16°53'02"E
L7	53.27	S21°35'02"E
L8	13.04	S27°43'15"E
L9	38.57	S32°11'08"E
L10	14.90	S34°50'55"E
L11	69.71	S00°18'54"E
L12	83.32	S22°36'40"E
L13	27.75	N22°36'40"W

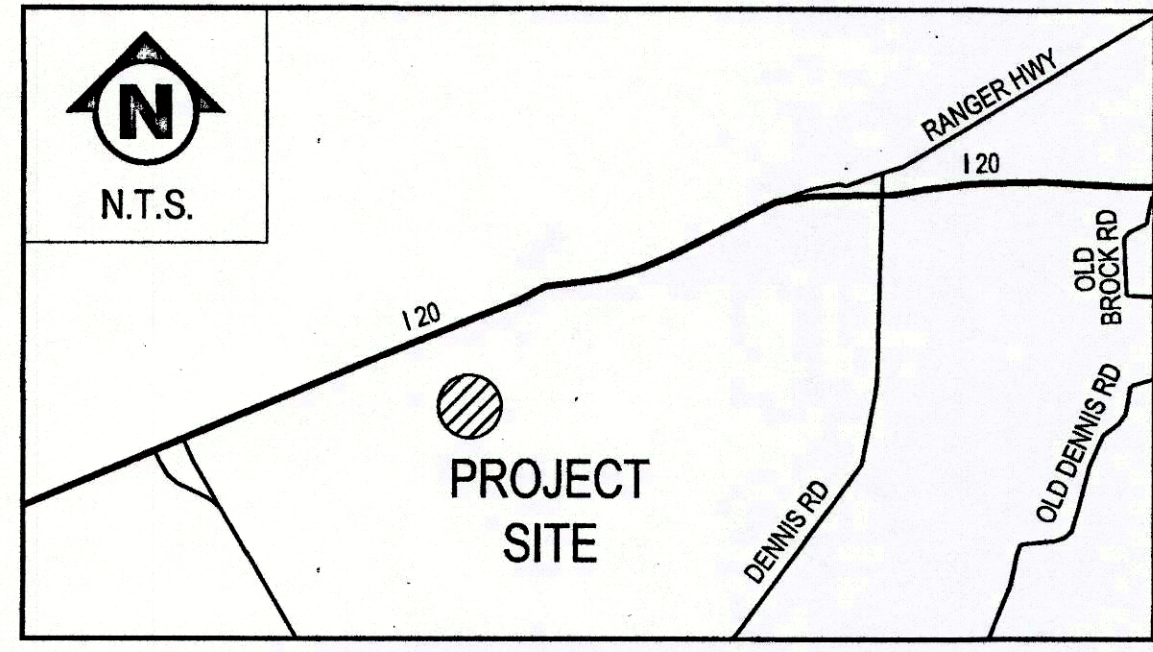

VICINITY MAP

CENTERLINE CURVE TABLE					
CURVE No.	LENGTH	RADIUS	DELTA	CHORD DIRECTION	CHORD LENGTH
C1	141.37	90.00	90°00'00"	S22° 23' 20"W	127.28
C2	141.37	90.00	90°00'00"	N67° 36' 40"W	127.28
C3	141.37	90.00	90°00'00"	N22° 23' 20"E	127.28
C4	141.37	90.00	90°00'00"	S67° 36' 40"E	127.28

RNS PROPERTIES, INC.  
 TRACT 1  
 DOC. NO. 201408541  
 O.P.R.P.C.T.

Δ 90°00'00"  
 R 120.00'  
 L 188.50  
 T 120.00  
 Ch B N67°36'40"W  
 Ch L 169.71'

C. MACKELHOFF SURVEY  
 ABSTRACT NO. 916

SANTO LAND & CATTLE COMPANY, LTD.  
 DOC. NO. 201202260  
 O.P.R.P.C.T.

STATE OF TEXAS ( )  
 COUNTY OF PARKER ( )

I hereby certify this plat is true and correct and was prepared from an actual survey of the property made under my supervision on the ground.

*Charles F. Stark* 8/14/18

Charles F. Stark, RPLS  
 Texas Registration No. 5084  
 August 10, 2018

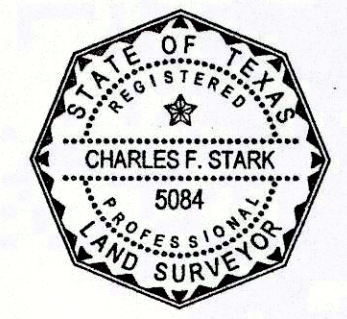

USE OF THIS ELECTRONIC SEAL/SIGNATURE AUTHORIZED BY CHARLES F. STARK, R.P.L.S., TEXAS REGISTRATION NO. 5084

ACCT. NO.: 11709  
 SCH. DIST.: B2  
 CITY: E-17  
 MAP NO.:

Final Plat

Lots 1 through 8, Block 1  
 Lots 1 & 2, Block 2

DAY 2 DAY BUSINESS PARK  
 PHASE 1

An Addition to Parker County, Texas

Being 23.57 acres Situated in the  
 A. GLOVER SURVEY, ABSTRACT NO. 1753  
 C.L. HEIFRIN SURVEY, ABSTRACT NO. 670  
 H. MINKEL SURVEY, ABSTRACT NO. 858  
 and the  
 C. MACKELHOFF SURVEY, ABSTRACT NO. 916  
 Parker County, Texas

21153.002.000.00 - All  
 20858.001.000.00 - All  
 20916.003.000.00 - 5.06 acs  
 20670.001.001.00 - 12.818 acs

FILED FOR RECORD  
 PARKER COUNTY, TEXAS PLAT RECORD  
 CABINET E, SLIDE 150  
 DATE \_\_\_\_\_

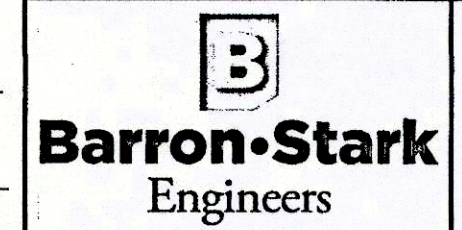

6221 Southwest Boulevard, Suite 100  
 Fort Worth, Texas 76132  
 (O) 817.231.8100 (F) 817.231.8144  
 Texas Registered Engineering Firm F-10998  
 Texas Registered Survey Firm F-10158800  
 www.barronstark.com

OWNER:  
 SANTO LAND & CATTLE COMPANY, LTD.  
 P.O. BOX 1708  
 WEATHERFORD, TEXAS 76086  
 PH. 817-992-6338  
 FAX 817-441-2094  
 CONTACT: JIM MARTIN

JOB No. 107-9478  
 DATE AUG. 2018  
 SHEET 1 of 2

USER: GARY GREEN  
 PLOTTED ON: 8/13/2018 4:54 PM  
 FILE: \\PARKER\GIS\PROJECTS\2018\201822574\201822574.DWG