

AZLELAND MEMORIAL GARDENS

JAMES R. EMANUEL, OWNER.

Scale 1" = 40'

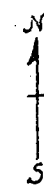

COUNTY

ROAD

N.E. cor. J. HALL SUR., Abst. 2308

1000'

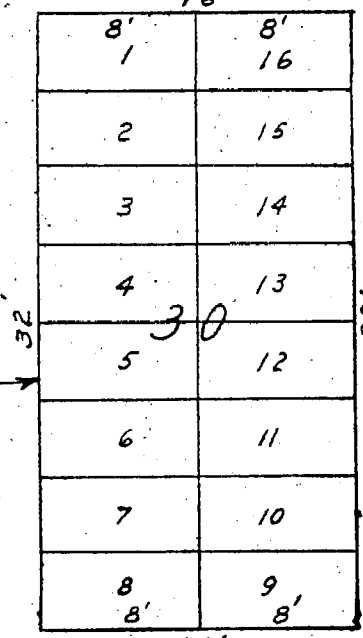
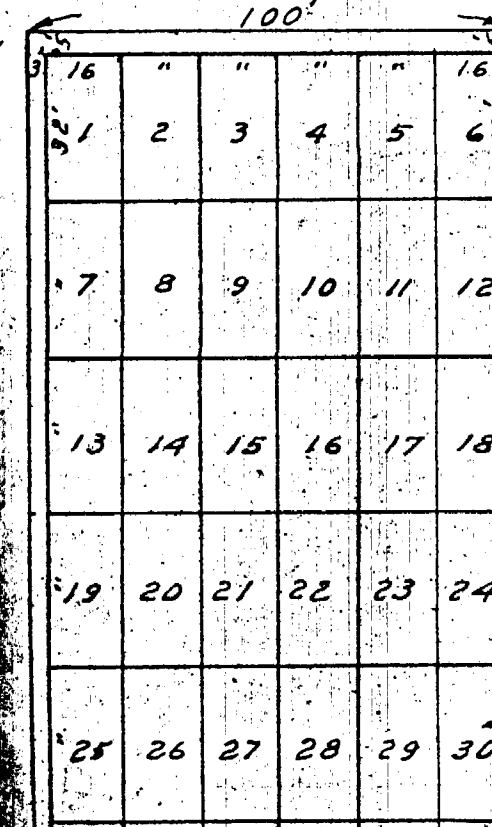
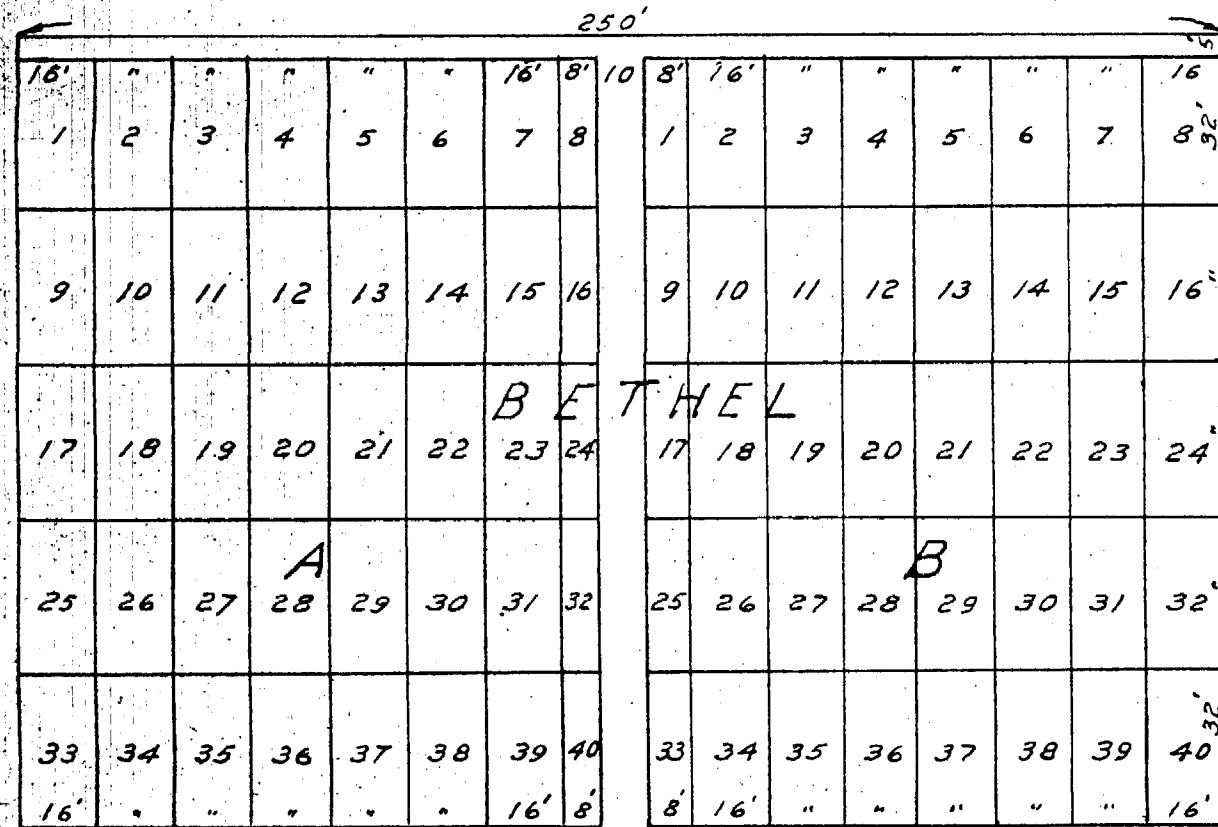
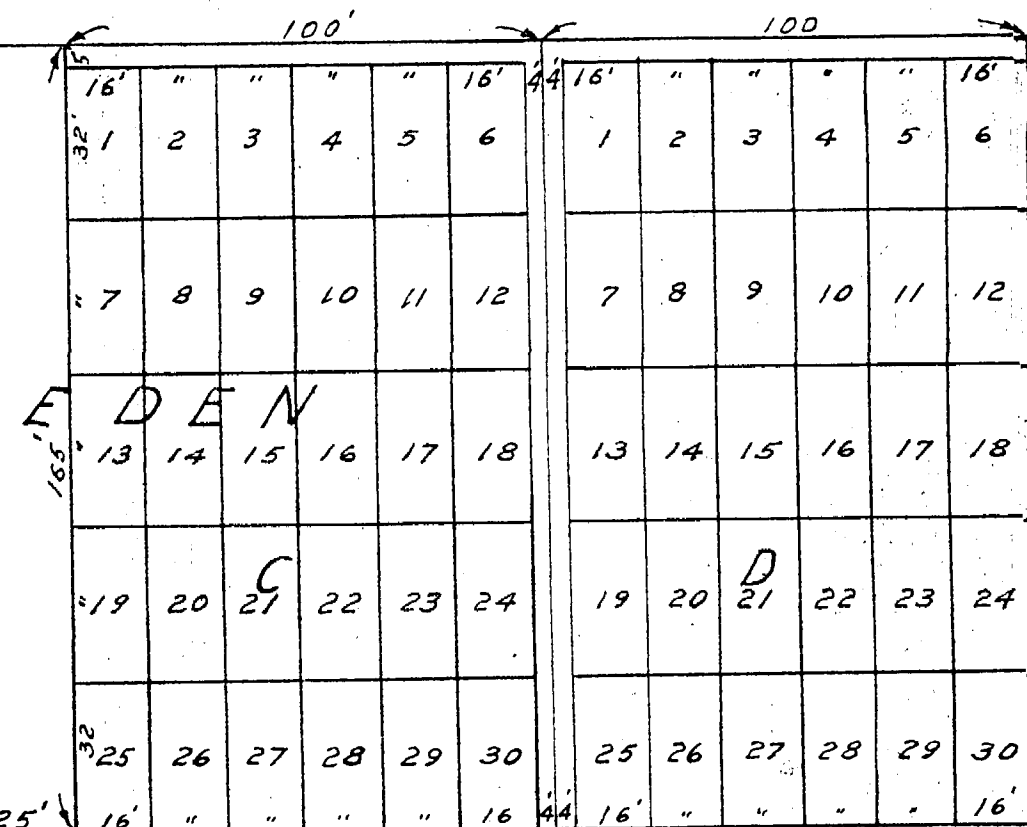

Typical Subdivision of all plots. Scale 1" = 10'.

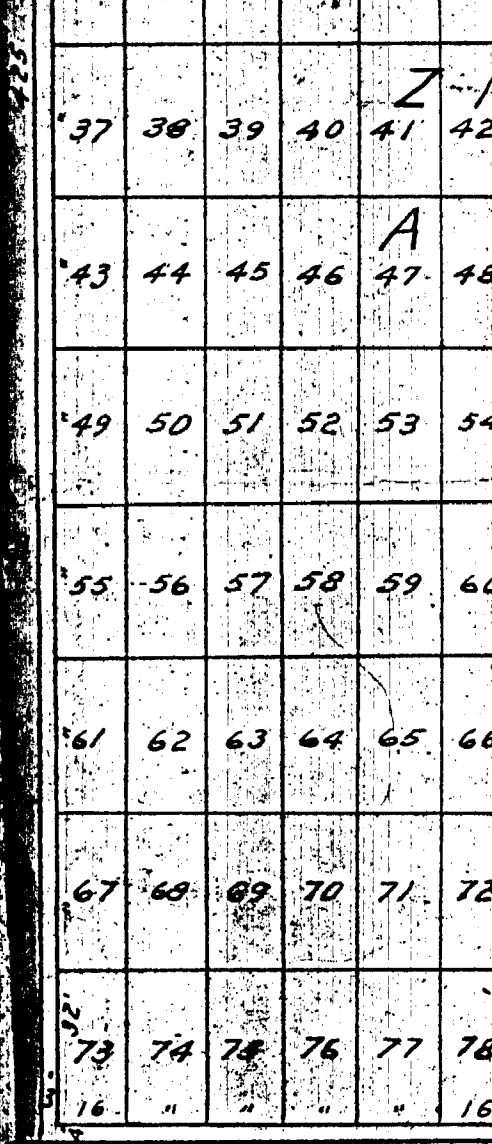
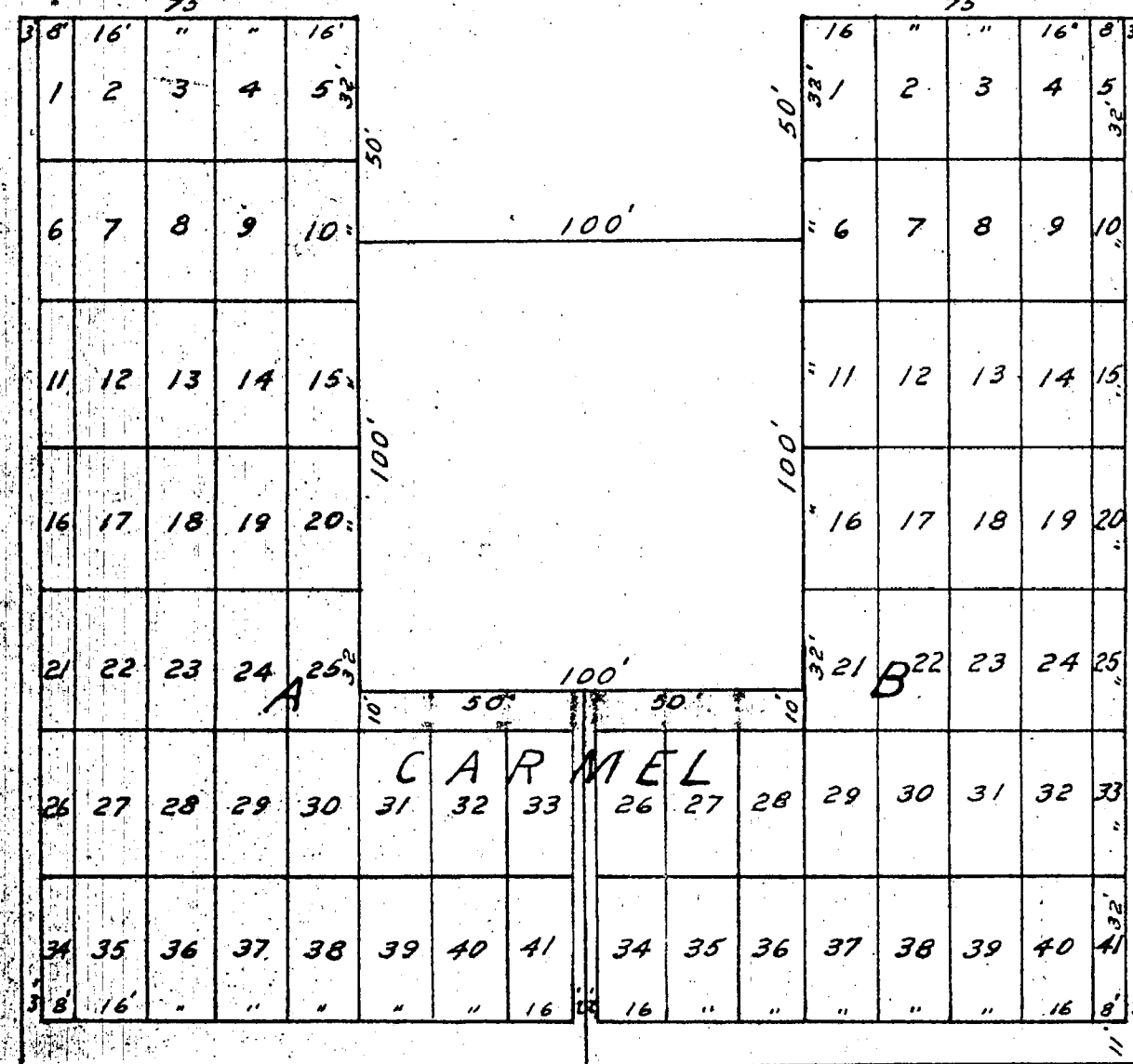
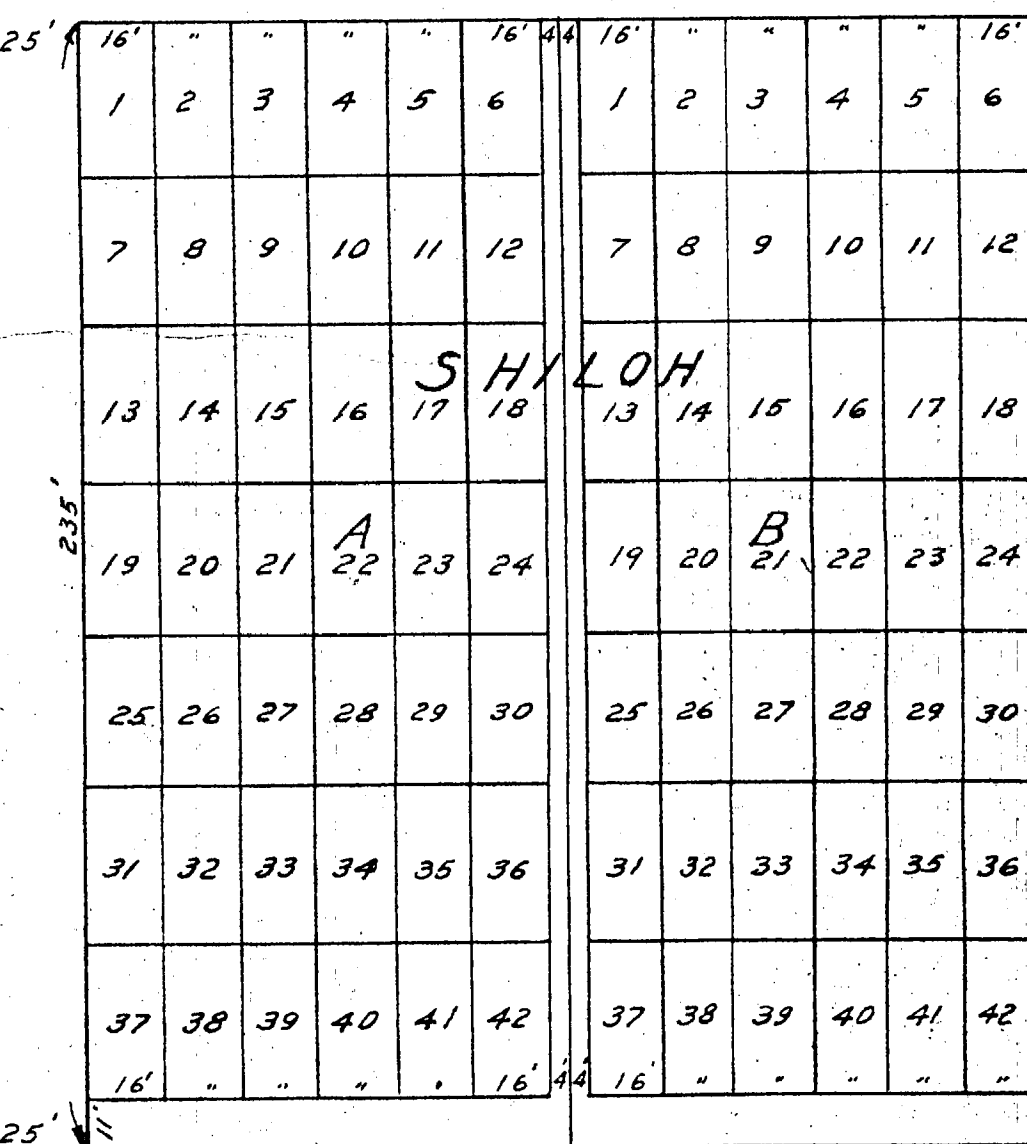

RECEIVED AND FILED FOR RECORD  
 At 8:00 o'clock a.m.  
 JUN 6 1962  
 CRVILLE MILDURN, County Clerk  
 TARRANT COUNTY, TEXAS  
 B. Merton

the above plat correctly represents a  
 made by me, dated the 25<sup>th</sup> day of May, A.D., 1962.  
 J. L. Corbin  
 Registered Public Surveyor No 1174, Azle, Texas.

ADD 17

COUNTY ROAD