

**ARZANIPOUR SUBDIVISION**  
 CREATING BLOCK-1: LOTS 1, 2, AND 3 AND  
 BEING A PART OF LOTS 9, 10, 11 AND 12, BLOCK  
 - 4, OF THE OWENS AND WILBANKS ADDITION.  
 WEATHERFORD, PARKER COUNTY, TEXAS  
 AND  
 BEING A PART OF THE P. S. HALL SUR. AB-659.

This plat or field note description is not intended to express or imply a warranty or guarantee of ownership or that there are no encumbrances on the tract described. The certification herein is only to the person who commissioned the survey and the surveyor will only be responsible for errors in an amount no greater than the fee charged.

203705 PCA-726  
 RECEIVED AND FILED FOR RECORD  
 9:15 o'clock P.M.  
 AUG 12 1991  
 CARRIE REED, Co. Clerk  
 PARKER COUNTY, TEXAS

STATE OF TEXAS COUNTY OF PARKER  
 I hereby certify that this instrument was filed on this date and time stamped herein by me and was duly recorded in the volume and page of the named records of Parker County as stamped hereon by me.  
 AUG 12 1991  
 Carrie Reed  
 County Clerk, Parker County, Tex.

DEDICATION  
 FIELD NOTES  
 FIELD NOTES of a 0.88 Acre tract of land, being a part of the P.S. Hall Survey, Abstract 659 and being a part of Lots 9, 10, 11 and 12, Block 4, of the OWENS AND WILBANKS ADDITION to the City of Weatherford, Parker County, Texas and being that tract of land deeded to Siroos Arzanipour in Vol. 1407, Page 815, Deed Records, Parker County, Texas dated Feb. 24, 1988 and being more fully described by metes and bounds as follows:  
 BEGINNING at a (fd) 1" steel pipe in the NBL of West Park Avenue, said point being the S.E. Corner of Lot 9, Block 4, of the Owens and Wilbanks Addition and being S 12 deg. 11 min. 31 sec. E., 839.53 ft. from the N.W. Corner of the P.S. Hall Survey;  
 THENCE N 00 deg. 27 min. W., 252.16 ft. to a (fd) 3/8" steel rod in the SBL of Rentz Street for a corner;  
 THENCE, with the SBL of the above mentioned Rentz Street S 55 deg. 20 min. W., 222.50 ft. to a (fd) steel "T" post for a corner;  
 THENCE S 00 deg. 42 min. W., 162.73 ft. to a (fd) 1/2" steel rod in the NBL of the above mentioned West Park Avenue, for a corner;  
 THENCE, with the NBL of said West Park Avenue, N 78 deg. 46 min. E., 190.62 ft. to the place of beginning and containing 0.88 Acres (38,371.72 sq. ft.) of land more or less.

THE STATE OF TEXAS COUNTY OF PARKER  
 WHEREAS, WE (I) Siroos Arzanipour and Georgia Arzanipour are the owner(s) of the above described part of Lots 9, 10, 11 & 12, Block 4, of the Owens and Wilbanks Addition to the City of Weatherford, Parker County, Texas, DO HEREBY ADOPT THE FOREGOING PLAT TO BE KNOWN AS ARZANIPOUR SUBDIVISION, Weatherford, Parker County, Texas and do hereby dedicate to the public use forever the streets and easements shown thereon.  
 IN WITNESS WHEREOF THIS DEDICATION IS EXECUTED.

This the 7 day of August 1991.

*Georgia C. Arzanipour*  
*Siroos Arzanipour*

THE STATE OF TEXAS COUNTY OF PARKER  
 BEFORE ME, the undersigned, a Notary Public, in and for said County and State on this day personally appeared Siroos Arzanipour and Georgia Arzanipour known to me to be the person(s) whose name(s) is/are subscribed to the above and foregoing instrument, and acknowledged to me that he/she (they) executed the same for the purposes and considerations expressed therein.  
 GIVEN UNDER MY HAND AND SEAL OF OFFICE THIS THE 7 day of August, 1991.

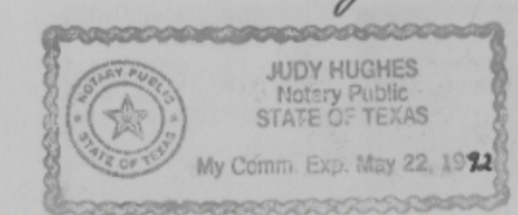

*Judy Hughes*  
 Notary Public for the State of Texas  
 Print Name: *Judy Hughes*  
 Commission expires: *5-22-92*

THE STATE OF TEXAS COUNTY OF PARKER  
 The undersigned as lien holder(s) on the acreage subdivided according to this plat, hereby consent to such subdivision join in the dedication of the streets and easements.

*Texas Bank*  
*Larry C. Porter V.P.*

THE STATE OF TEXAS COUNTY OF PARKER  
 BEFORE ME, the undersigned authority, on this day personally appeared *Larry C. Porter Vice President Texas Bank* known to me to be the person(s) whose name(s) is subscribed to the foregoing instrument, and acknowledged to me that he/she (they) executed the same for the purposes and consideration therein expressed, in the capacity therein stated.  
 GIVEN UNDER MY HAND AND SEAL OF OFFICE THIS THE 7th day of August, 1991.

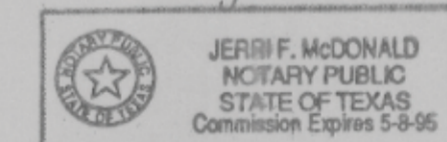

*Jerrif F. McDonald*  
 Notary Public, Parker County, Texas  
 Print Name: *JERRIF F. McDONALD*  
 Commission Expires: *5-8-95*

THE STATE OF TEXAS COUNTY OF PARKER  
 BEFORE ME, the undersigned authority, on this day personally appeared \_\_\_\_\_ known to me to be the person(s) whose name(s) is subscribed to the foregoing instrument, and acknowledged to me that he/she (they) executed the same for the purposes and consideration therein expressed, in the capacity therein stated.  
 GIVEN UNDER MY HAND AND SEAL OF OFFICE THIS THE \_\_\_\_\_ day of \_\_\_\_\_, 1991.

Notary Public, Parker County, Texas  
 Print Name: \_\_\_\_\_  
 Commission Expires: \_\_\_\_\_

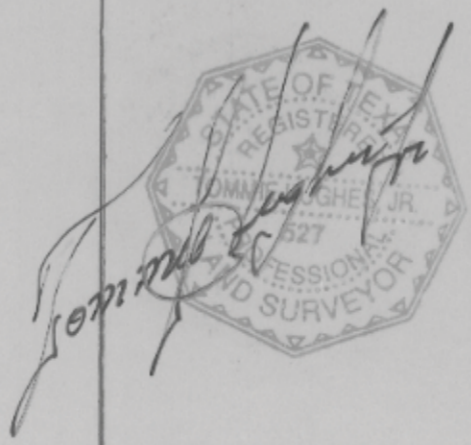

APPROVED BY THE CITY OF WEATHERFORD, TEXAS, PURSUANT TO THE AUTHORITY DELEGATED TO THE CITY SECRETARY UNDER SECTION 2.5, ARTICLE 2 ORDINANCE 1991-1 AND SECTION 212.0065, TEXAS LOCAL GOVERNMENT CODE ALLOWING FOR ADMINISTRATIVE APPROVAL OF CERTAIN PLAT VACATIONS, CORRECTIONS, REPLATS OR MINOR PLATS AS DESCRIBED THEREIN.  
 8-7-91  
*Gloria Wood*  
 Gloria Wood  
 City Secretary  
 City of Weatherford, Texas

\* NOTE: I, *Siroos Arzanipour*, do hereby waive all claims for damages against the City occasioned by the establishment of grades or the alteration of the surface of any portion of the existing streets and alleys, or natural contours, to conform to the grades established in the subdivision.

\* NOTE: There are no deed restrictions.

HUGHES AND ASSOCIATES  
 LAND SURVEYING  
 CIVIL ENGINEERING  
 LAND PLANNING  
 111 E. COLUMBIA, SUITE 100 WEATHERFORD, TEXAS  
 OFFICE 594-5334 OR 481-7015 HOME 594-2145

*Jerry Hughes*  
 I certify that this map was prepared from notes of an actual survey made by me or under my supervision and to the best of my knowledge and belief represents said survey.

Date *8/7/91* No. *14988*